



SHOCKLEY ENGINEERING AND SURVEYING

200 S. RICE AVE. HAMILTON, TEXAS 76531
OFFICE PH. 254-386-8580

FIELD NOTES

THE STATE OF TEXAS

CORYELL COUNTY

All that certain tract or parcel of land situated in Coryell County, Texas, being 185.554 acres of land out of the Bernhard Eilers Survey A-323 and being all of that 172.717 acre tract described in Deed to Jason S. Faubian per Instrument No. 115181 Coryell County Deed Records, said 185.554 acre tract described by metes and bounds as follows;

Beginning at a steel pin set at the base of a 6 inch cedar corner post being in the West line of F. M. Highway 116, said pin the NEC of this;

THENCE S19-30-06W (all GPS bearings) along the fenced West line of said Highway, at 74.58 feet a steel pin set, the P.C. of a curve to the Right, a steel pin set;

THENCE along the arc of said circular curve with curve data as follows; R=3759.83 feet, arc=1445.5 feet and chord= S30-05-48W, 1436.61 feet; a steel pin set;

THENCE S40-58-56W along Highway west line, at 884.1 feet a steel pin found with RPLS 4327 cap, the NEC of the adjoining Markie D. Necessary 120.929 acre tract per Instrument No. 184474 and the SEC of this;

THENCE N65-06-01W along the fenced South line of this, at 3729.01 feet a steel pin found with RPLS 4327 cap at the base of a 6 inch cedar corner post, the SWC of this;

THENCE N16-41-45E along the East line of the adjoining Billie Thomas tract per Vol. 210 , page 485 said Deed Records, at 1572.62 feet passing a 6 inch cedar corner post being the occupied NWC of this with North fence line offset 14.5 feet due to an old rock fence and erosion ditch, at 1587.12 feet a steel 2 inch section found at the base of a corner post, the SWC of the adjoining Louis Bone tract per Vol.267, page 147, said Deed Records; and the NWC of this;

THENCE S 75-21-55E along the trace of an old fence, at 168.84 feet the calculated point of deviation, and continue along the fenced North line of this, at 4393.97 feet the Point of Beginning and containing 185.554 acres of land.

All Real Property Improvements located hereon lie well above the flood plain for the said B. Eilers Survey, Ref. FIRM Panel 480768-0200B, 30 Sept. 1981.

Surveyed; 21 Mar. 2006
For, Jason Faubion

Rodmen; Brandon Buffe

I, Harold J. Shockley, Registered Professional Land Surveyor of the State of Texas, hereby certify that the foregoing survey was made by me, on this date, on the ground, and that the corners are marked as indicated on the plat attached hereto.

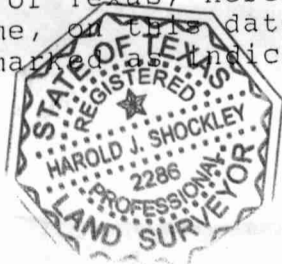

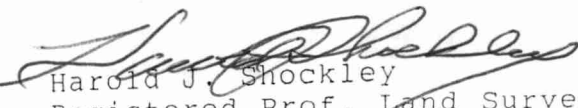
Harold J. Shockley
Registered Prof. Land Surveyor
No. 2286 of Texas



SHOCKLEY ENGINEERING AND SURVEYING

200 S. RICE AVE. HAMILTON, TEXAS 76531
OFFICE PH. 254-386-8580

THE STATE OF TEXAS
CORYELL COUNTY

Plat showing survey of 185.554 acres of land out of the Bernhard Eilers Survey, A-323, Coryell County, Texas.

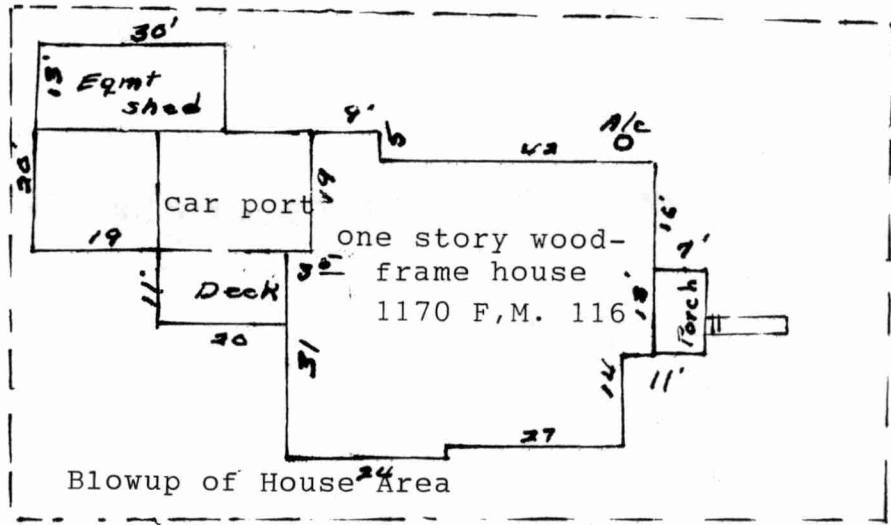

Bernhard EILERS SURV.
A-323

L. Bone
267/147

J. Faubion
115181
172.712 ac.

185.554 AC

R=3759.83'
Arc 1445.5'

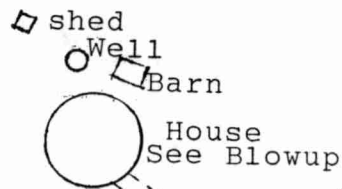

M. Necessary
184474
120.929 ac.

- STEEL PIN FOUND
- STEEL PIPE FOUND
- ⊙ STEEL PIN SET

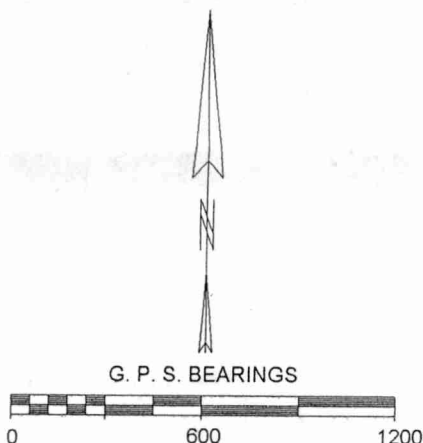

MARCH 22, 2006
JASON FAUBION

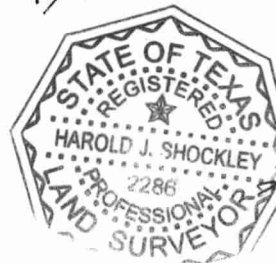

HAROLD J. SHOCKLEY
REG. PROF. LAND SURVEYOR
NO. 2286, STATE OF TEXAS

COPYRIGHT MATERIAL ; USE OF THIS SURVEY FOR ANY
PURPOSE OTHER THAN HTIS TRANSACTION IS PROHIBITED.